



WAVEPACK



WaveWrap® packaging machine

Instruction Manual



WAVEPACK

Contact information

WavePack® GmbH

Fabrikstraße 15
79771 Klettgau-Erzingen (DE)

Telephone: +49 (0) 7742 9169 195
Website: www.WaveWrap.eu
E-Mail: info@WaveWrap.eu

Information about the product

Product name: WaveWrap® packaging machine
Type: see identification plate
Serial number: see identification plate

Document

Name: Instruction Manual WaveWrap®
Edition: Rev00
Date: 07/2019

The original instruction manual was drawn up in German.



Contents

1	User information	1
1.1	About this instruction manual.....	1
1.1.1	Storage and circulation of this instruction manual	1
1.1.2	Target group of this instruction manual	1
1.1.3	Validity of the instruction manual	1
1.1.4	Structure of the instruction manual.....	2
1.1.5	Presentation	2
1.1.6	Warnings in the instruction manual.....	2
1.1.7	Symbols in the instruction manual.....	3
1.2	Copyright.....	3
1.3	Guarantee	3
2	Safety	4
2.1	Hazards.....	4
2.1.1	Electrical power.....	4
2.1.2	Sharp and sharp-edged components	4
2.2	Intended use of the machine.....	5
2.3	Qualification of personnel	6
2.3.1	Specialised persons	6
2.3.2	Qualified persons	6
2.3.3	Authorised persons	6
2.4	Owner responsibilities	6
3	Transport, installation and connection	7
3.1	Delivery contents	7
3.2	Packaging.....	7
3.3	Setting up the machine	8
3.4	Connection.....	9
4	Operation.....	10
4.1	Switching on the packaging machine	10
4.2	Adjusting the clamping bar.....	11
4.3	Packaging the product	12
4.3.1	Reset button	13
5	Maintenance.....	14
5.1	Safety Instructions for Maintenance.....	14
5.2	Troubleshooting.....	14
5.3	Removal of jammed product.....	15
5.4	Replacing the blade.....	16
5.5	Replacing the fuse	18
5.6	Cleaning.....	19
5.6.1	Cleaning the housing	19
5.6.2	Removing cardboard residues.....	20
6	Decommissioning and disposal	22
6.1	Decommissioning.....	22
6.2	Disposal.....	23
7	Technical data.....	24
7.1	Machine dimensions	24



WAVEPACK

7.2	Information plate and further electrical characteristics.....	24
8	Appendix.....	25
8.1	EC Declaration of Conformity	25

1 User information

1.1 About this instruction manual

The manufacturer WavePack® GmbH (hereafter referred to as WavePack®) will deliver the product to you complete and functionally reliable. This instruction manual explains how to:

- ▶ set up the machine;
- ▶ connect it to the mains;
- ▶ operate the machine;
- ▶ troubleshoot problems;
- ▶ dispose of the product.

It is essential that you read this manual thoroughly and completely before operating the machine. We endeavour to provide you with all the information you need for safe and complete service. However, should you have any questions that are not answered in this instruction manual, please contact WavePack®.

1.1.1 Storage and circulation of this instruction manual

This instruction manual and all product-related documentation relevant for the respective application must always be kept at hand and accessible at all times in the vicinity of the machine.

1.1.2 Target group of this instruction manual

This instruction manual is intended for:

- ▶ **Operating personnel**
These persons have been instructed about the machine and are informed about possible dangers in the event of improper use.
- ▶ **Skilled personnel**
Trained specialists are familiar with the handling of electrical and mechanical devices. A skilled worker is someone who, due to his technical training, knowledge and experience as well as knowledge of the relevant regulations, is able to assess the work assigned to him and recognize possible hazards.

1.1.3 Validity of the instruction manual

The instruction manual becomes valid when the WavePack® product is handed over to the owner. The revision number and release date of this instruction manual are shown in the footer. This instruction manual may be changed at any time without explanation.

NOTE



This edition of the instruction manual replaces all previous versions.

1.1.4 Structure of the instruction manual

This instruction manual has been divided into sections. The sequence of the sections is intended to help put the product into operation quickly and safely.

1.1.5 Presentation

1. Step in the procedure

↳ Result of an action

(a) = Graphic reference

1.1.6 Warnings in the instruction manual

This manual contains warning notices before instructions which could result in personal injury or damage to property. The described measures for averting danger must be observed.

Warnings are structured as follows:

HAZARD!



SOURCE AND CONSEQUENCE

Explanation if necessary.

- ▶ Prevention.
- ▶ In case of emergency.

- ▶ Warning symbol: (Warning triangle) draws attention to the hazard.
- ▶ Signal word: Indicates the severity of the hazard.
- ▶ Source: Indicates the nature or source of the hazard.
- ▶ Consequence: Describes the consequences of non-compliance.
- ▶ Prevention: Indicates how to avoid the hazard.
- ▶ In case of emergency: Indicates which measures are required should the hazard occur.

HAZARD!



Indicates an imminent major hazard which, if not avoided, is certain to result in death or serious injury.

WARNING!



Indicates a potentially hazardous situation which, if not avoided, could result in death or serious injury.

CAUTION!



Indicates a potentially hazardous situation which, if not avoided, could result in moderate or light injury or property damage.

NOTE



Paragraphs with this symbol provide important information about the product or the handling of the product.

1.1.7 Symbols in the instruction manual

General warning symbol.



Warning of electrical voltage.



Warning of the risk of cutting injuries.



Warning of danger of crushing.



Warning of risk of injury from heavy and unwieldy equipment.

1.2 Copyright

This instruction manual contains information protected by copyright. The contents or extracts thereof may not be copied or reproduced in any other form without the prior permission of the manufacturer.

1.3 Guarantee

Within the 12-month warranty period, the authorised dealer assumes the costs for service or maintenance; including spare parts and excluding wear parts and the converter. After the warranty period, the owner bears all expenses and costs for the repair and maintenance service including working hours, travel expenses, fees, spare parts and wear parts.

2 Safety

This section summarises all the information needed in order to operate the packaging machine safely.

2.1 Hazards

The machine has been built in accordance with the statutory regulations applicable at the time of delivery and is up to date in terms of safety technology. Any residual dangers are identified by safety instructions and are described in the instruction manual.

All safety instructions on the machine must be observed and must always be present and clearly legible. The machine may only be operated if all safety devices are present.

This section describes the potential hazards that may be caused by the packaging machine.

2.1.1 Electrical power

It must generally be assumed that the machine, or parts of it, is under voltage.

WARNING!



RISK OF ELECTRIC SHOCK DURING INSTALLATION, CLEANING AND MAINTENANCE WORK!

Dangerous voltage on exposed live parts.

- ▶ Switch off the packaging machine during installation, cleaning and maintenance work.
- ▶ Disconnect the packaging machine from the mains.
- ▶ During maintenance work, ensure the absence of voltage on all poles.

2.1.2 Sharp and sharp-edged components

CAUTION!



RISK OF CUTTING HANDS!

The mechanically driven blades can cause serious injury to hands.

- ▶ Do not reach into the housing.
- ▶ Switch off the packaging machine during installation, cleaning and maintenance work.
- ▶ Disconnect the packaging machine from the mains.
- ▶ Wear protective gloves during maintenance and cleaning work.

CAUTION!



DANGER OF CRUSHING FROM THE DRAWER!

There is a risk of injury to hands when closing the drawer.

- ▶ Use the handle only when opening and closing the drawer.
- ▶ Do not reach into the opening.

2.2 Intended use of the machine

The WaveWrap® packaging machine may only be used for manually loaded packaging of small parts and may only be used for commercial and industrial purposes.

The packaging machine is exclusively approved for the areas of application specified in the instruction manual. Any other uses, modifications or alterations are not permitted and may be dangerous.

You act in accordance with the intended purpose:

- ▶ When the machine is operated exclusively with the lid closed;
- ▶ When packages with approved dimensions and weights are packed;
- ▶ When only WavePack® approved packaging material is used;
- ▶ When the machine is used indoors;
- ▶ When the machine is operated stationary;
- ▶ When the instructions and action sequences are strictly adhered to and no unauthorised external actions are carried out that endanger your safety and the proper functioning of the packaging machine!
- ▶ When all the safety instructions given are followed.

Misuse

- ▶ Non-observance of the safety instructions and instructions for installation, operation, maintenance and disposal given in the instruction manual;
- ▶ Packaging of hazardous substances or liquids;
- ▶ Modifications and changes to the packaging machine;
- ▶ Use of unauthorised or modified packaging material;
- ▶ The product is not suitable for use in hazardous areas and must therefore not be operated in such areas. The product is not explosion-proof;
- ▶ Operation in a condition in which live parts are accessible;
- ▶ Manipulation or circumvention of existing safety devices;
- ▶ Use under terms and conditions other than those specified by the manufacturer in the related technical documentation, data sheets, instruction manual and other specific guidelines.

WavePack® only guarantees that the device meets its published specifications. If the product is used in a way that is not described in this instruction manual, the cover of the device is affected and the warranty claim is lost.

2.3 Qualification of personnel

This instruction manual refers at various points to the qualifications of groups of persons who may be entrusted with the various tasks involved in installation, operation and maintenance. These three groups are:

- ▶ Specialised persons
- ▶ Qualified persons
- ▶ Authorised persons

This machine is not suitable for use by individuals (including children) who are physically or mentally handicapped or do not have the necessary experience or knowledge of the product, unless they are supervised or have received thorough instruction in the use of the equipment by a person responsible for the safety of such persons.

2.3.1 Specialised persons

Specialised persons are, for example, fitters or electricians who can perform various tasks such as transport, installation and maintenance of the product under the supervision of an authorised person. The persons concerned must have experience in handling the product.

2.3.2 Qualified persons

Persons who, through their specialist training, possess sufficient knowledge in the required field and are familiar with the relevant national industrial safety regulations, accident prevention regulations, guidelines and recognised rules of technology. Qualified personnel must be able to safely assess the results of their work and be familiar with the contents of this instruction manual.

2.3.3 Authorised persons

Authorised persons are those who are either required by law to perform the relevant activity or who have been approved by WavePack® for certain activities.

2.4 Owner responsibilities

The risk of accidents is reduced if the owner of the packaging machine observes the following points:

- ▶ Compliance with statutory regulations on accident prevention, occupational safety and environmental protection.
- ▶ Monitoring of the cleanliness of the packaging machine, the packages and the workplace.

The responsibilities for operating the packaging machine must be clearly defined by the owner. The operating personnel must be regularly instructed.

The operators of equipment with an electrical power source must be instructed by the owner regarding potential hazards, necessary safety measures and the applicable safety regulations, before starting work.

3 Transport, installation and connection

3.1 Delivery contents

- Packaging machine
- Power cable with device plug
- Instruction manual

Check the delivery contents with the shipping documents and report any damage immediately.

3.2 Packaging

It is recommended to move or transport the packaging machine in the original box or in the original packaging. Disconnect the power cord from the power supply before moving or lifting the packaging machine.

⚠ CAUTION!



RISK OF INJURY FROM HEAVY AND UNWIELDY MACHINERY!

- ▶ Prepare the place of installation.
- ▶ Machine to be unpacked and transported by at least 2 persons.



Fig.1 Unpacking / transporting the machine

3.3 Setting up the machine

Transport and installation work may only be carried out by qualified personnel (see section 2.3).

NOTE



Prepare an appropriately sized ergonomic workstation, observing also the following installation conditions:

- ▶ The packaging machine may only be installed indoors.
- ▶ The place of installation must be dry and well lit.
- ▶ The table must be horizontally aligned and have sufficient load-bearing capacity.
- ▶ The main switch and the reset button on the back of the unit must be easily accessible.

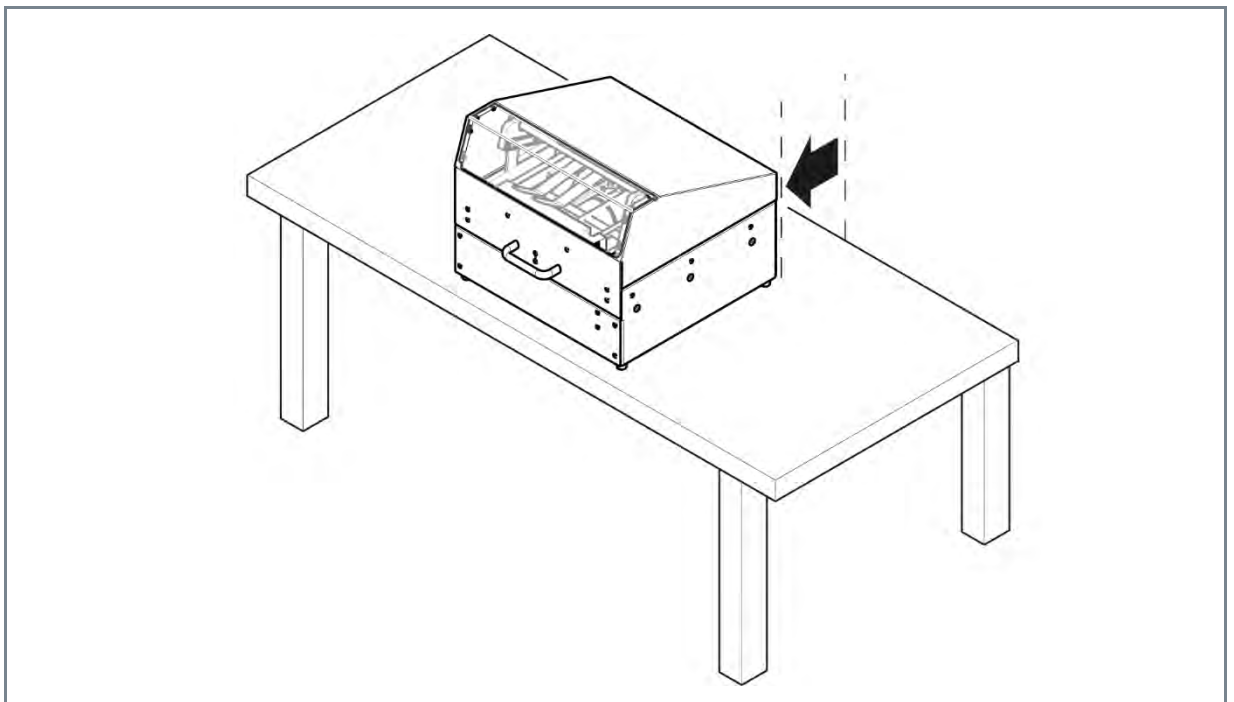

Fig. 2 Setting up the machine

3.4 Connection

Electrical installation work may only be carried out by qualified personnel (see section 2.3).

⚠ WARNING!



DANGER OF FIRE, SHORT-CIRCUIT OR ELECTRIC SHOCK!

- ▶ Observe the national regulations applicable in the respective country of use.
- ▶ Only connect the machine to a power supply with protective conductor.
- ▶ Never connect or disconnect the machine from the mains under load or voltage.

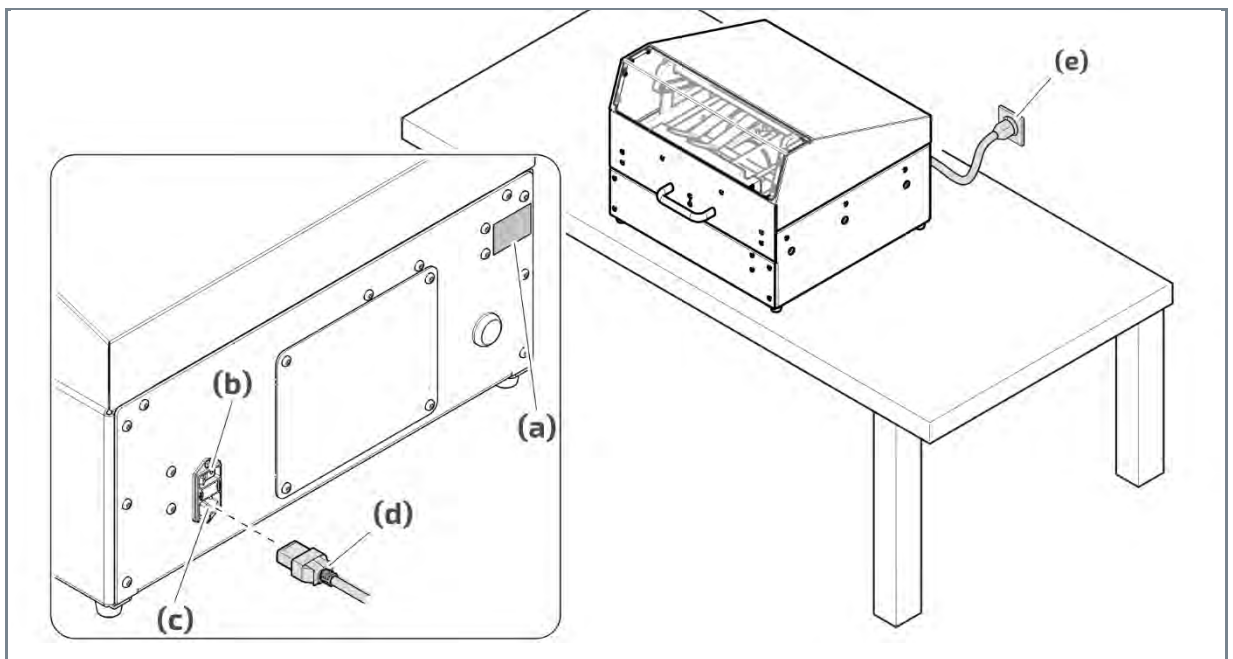

Fig. 3 Connecting the packaging machine

1. Check the existing mains voltage with the voltage indicated on the identification plate **Fig. 3 (a)** for conformity.
2. Switch the main switch **Fig. 3 (b)** of the packaging machine to "0".
3. Plug the power cable **Fig. 3 (d)** into the socket on the machine **Fig. 3 (c)**.
4. Connect the mains plug of the power cable **Fig. 3 (e)** to a power socket.
 - ↳ The machine is properly installed and connected.

4 Operation

The packaging machine may only be operated by qualified operating personnel (see section 2.3).

WaveWrap® is based on a sheet of corrugated cardboard with which the packaged product is wrapped. All sheets are coated on one side with an adhesive, which fixes the product during packaging, without leaving residues. Because the product is wrapped and lightly fixed by the entire WaveWrap® sheet, there is leeway in the use of the sheet sizes, as long as there is sufficient lateral projection and overlap on the upper side.

4.1 Switching on the packaging machine

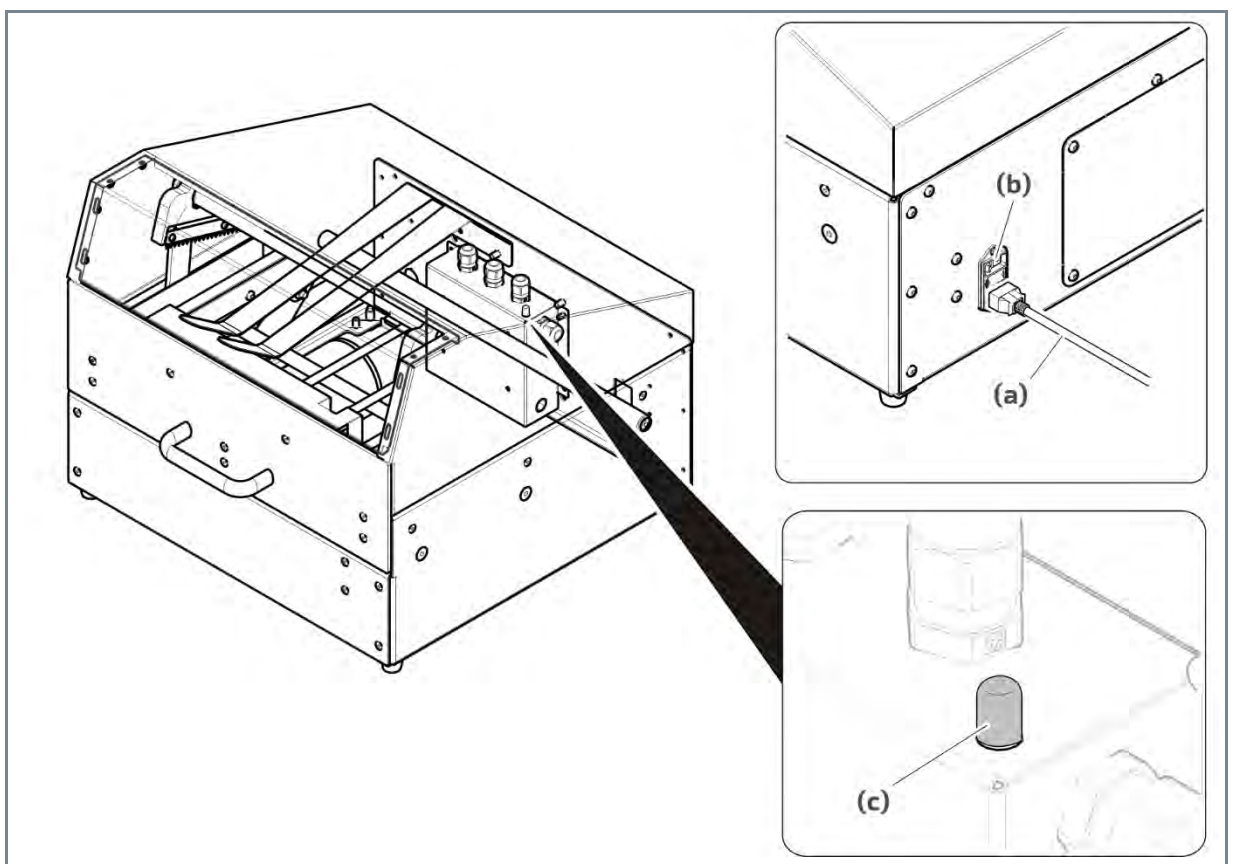

Fig. 4 Switching on the packaging machine

1. Make sure that the power cable **Fig. 4 (a)** is plugged in correctly.
2. Switch the main switch **Fig. 4 (b)** on the back of the machine to "1".
3. Check whether the indicator lamp **Fig. 4 (c)** inside the housing lights up.
 - ↳ If the green control lamp lights up, the machine is ready for operation.
 - ↳ Observe the information in section 5.2 Troubleshooting, if the indicator lamp does not light up.

4.2 Adjusting the clamping bar

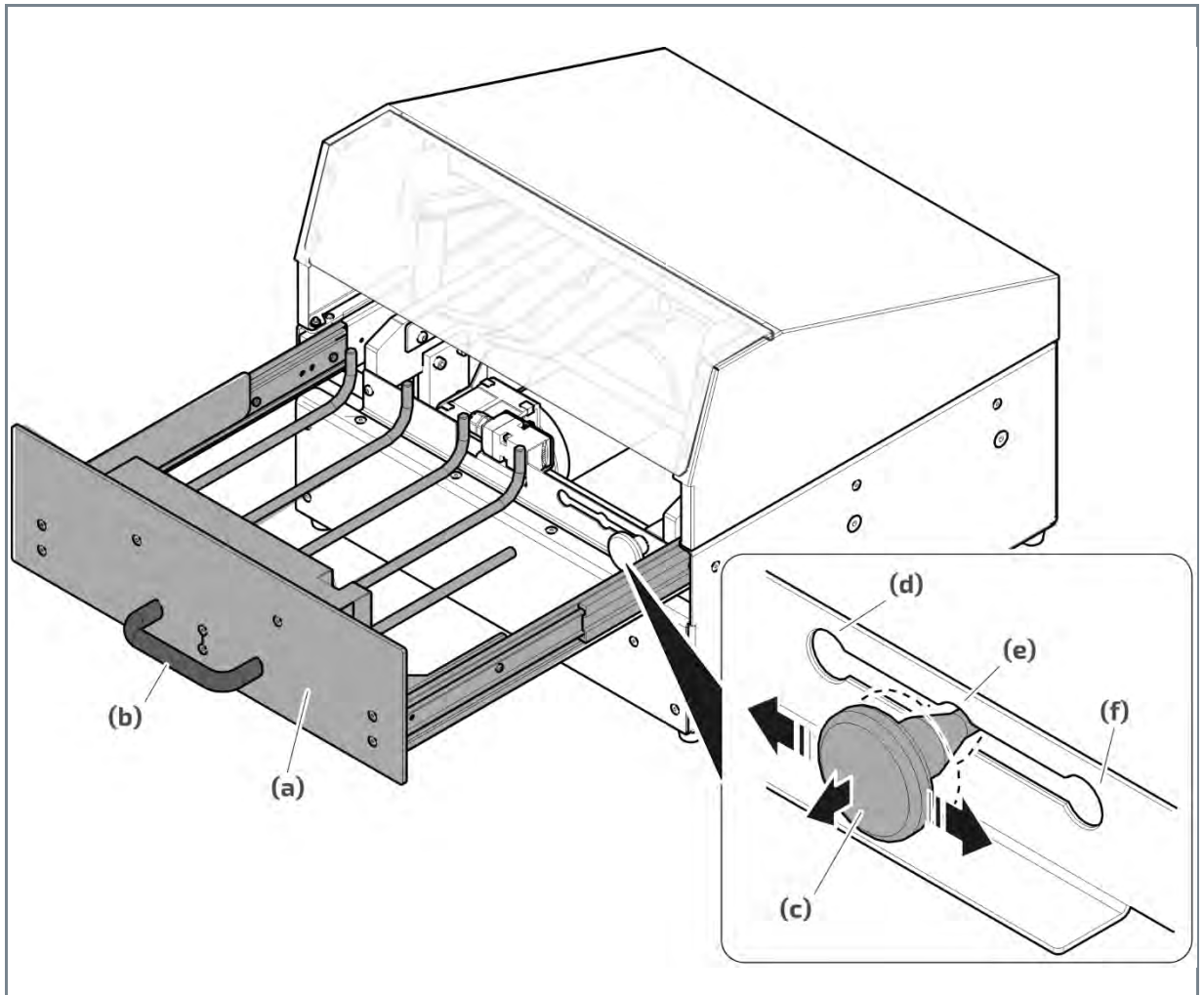

Fig. 5 Adjusting the clamping bar

1. Use the handle **Fig. 5 (b)** to pull the drawer **Fig. 5 (a)** completely out of the housing.
2. Pull the lever **Fig. 5 (c)** and move the clamping bar into the recess of the appropriate size of the blank to be used:
 - Sheet size 1 (small) **Fig. 5 (d)**: 300 mm x 350 mm
 - Sheet size 2 (medium) **Fig. 5 (e)**: 300 mm x 430 mm
 - Sheet size 3 (large) **Fig. 5 (f)**: 400 mm x 530 mm
3. Engage the lever in the recess.
 - ↳ The clamping bar is correctly adjusted.

4.3 Packaging the product

⚠ CAUTION!

PERSONAL INJURY AND DAMAGE TO PROPERTY!

Inserting unauthorised products may damage the equipment and result in personal injury.

- ▶ Do not pack any hazardous substances or liquids.
- ▶ Observe the permissible product dimensions and the maximum product weight.

⚠ CAUTION!

DANGER OF CRUSHING FROM THE DRAWER!

There is a risk of injury to hands when closing the drawer.

- ▶ Use the handle only to open and close the drawer.
- ▶ Do not reach into the opening.
- ▶ Leave the drawer open only during operation.
- ▶ Always close the drawer when leaving the workstation.

NOTE

- ▶ Use only WavePack® approved packaging materials and blanks.
- ▶ Do not pack fragile objects.
- ▶ Observe the permissible product dimensions.

Permitted product dimensions

	Sheet size 1	Sheet size 2	Sheet size 3
	Product dimensions	Product dimensions	Product dimensions
Height	min. 1 mm max. 40 mm	min. 1 mm max. 40 mm	min. 1 mm max. 40 mm
Length	max. 220 mm	max. 270 mm	max. 320 mm
Width	max. 150 mm	max. 190 mm	max. 240 mm

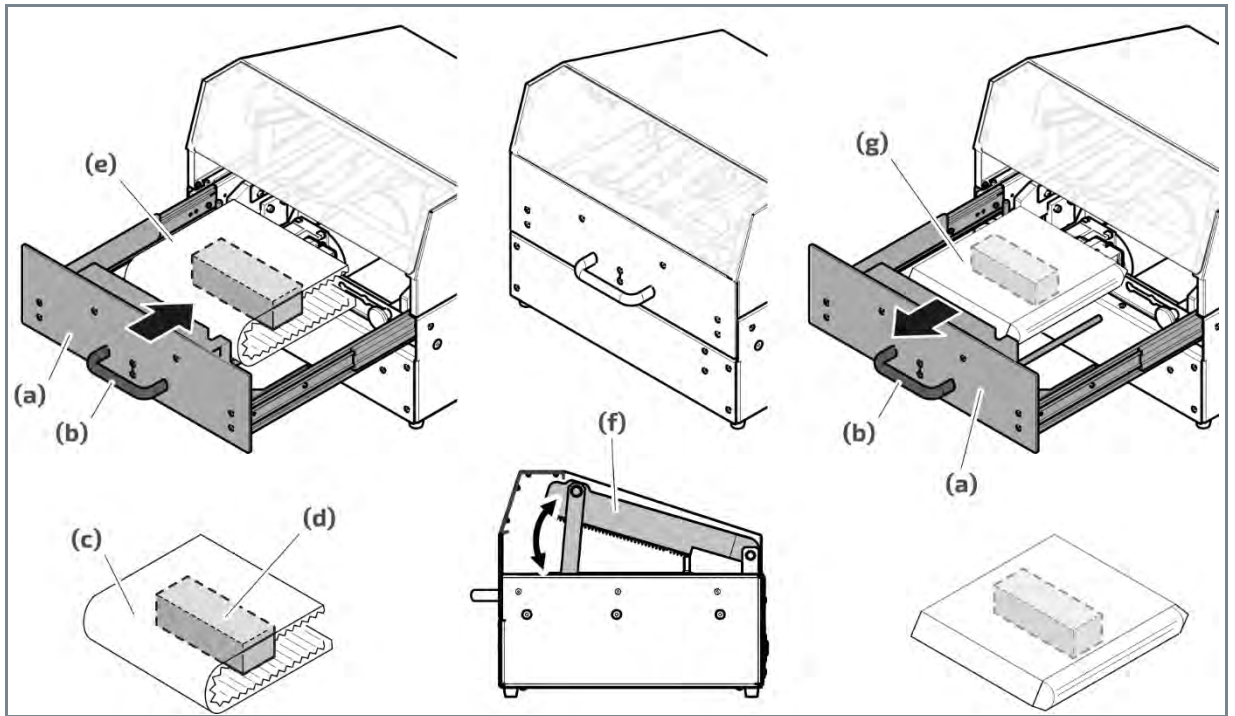

Fig. 6 Inserting and packaging the product

1. Use the handle **Fig. 6 (b)** to pull the drawer **Fig. 6 (a)** completely out of the housing.
2. Make sure that the clamping bar is set to the correct blank size **Fig. 6 (d) (e) (f)**.
3. Place the product **Fig. 6 (d)** in the centre of the corresponding blank **Fig. 6 (c)**.
4. Fold the blank over lengthwise and press the glued surfaces lightly together.
5. Place the package in the drawer **Fig. 6 (e)**.
6. Close the drawer.
 - ↳ The packaging process is started by closing the drawer and the blank is closed by the clamping bars pressing together **Fig. 6 (f)**.
7. When the process is completed, the drawer **Fig. 6 (a)** can be completely pulled out using the handle **Fig. 6 (b)**.
 - ↳ The finished package **Fig. 6 (g)** can be removed.

4.3.1 Reset button

NOTE



- ▶ In the event of a fault (e.g. jammed blank), press the reset button on the rear panel. The reset button can only be pressed when the drawer is closed and locked.
- ▶ When the reset button is pressed, the settings are zeroed.

5 Maintenance

Maintenance and troubleshooting may only be carried out by specialised personnel (see section 2.3). Maintenance, troubleshooting and cleaning work may only be carried out when the device is disconnected from the power supply.

5.1 Safety Instructions for Maintenance

WARNING!



RISK OF ELECTRIC SHOCK DURING MAINTENANCE AND CLEANING WORK!

Dangerous voltage on exposed live parts.

- ▶ Switch off the packaging machine during maintenance and cleaning work.
- ▶ Disconnect the packaging machine from the mains.
- ▶ During maintenance work, check that all poles are free of voltage.

CAUTION!



RISK OF CUTTING HANDS!

The mechanically driven blades can cause serious injury to hands.

- ▶ Switch off the packaging machine during installation, cleaning and maintenance work.
- ▶ Disconnect the packaging machine from the mains.
- ▶ Wear protective gloves during maintenance and cleaning work.

CAUTION!



DANGER OF CRUSHING FROM THE DRAWER!

There is a risk of injury to hands when closing the drawer.

- ▶ Use the handle only to open and close the drawer.

5.2 Troubleshooting

Fault	Cause	Solution
Blank is stuck	Blank and/or product jam.	Press reset button.
Blank is stuck	Operation was not completed. Drawer was opened too early.	Press reset button.
Product is jammed	Incorrectly set size on clamping bar. Invalid product size.	Open the housing. Remove jammed product.

5.3 Removal of jammed product

If the product jams during the packaging process due to incorrect insertion, incorrect adjustment of the clamping bar or incorrect product dimensions, the product must be removed from the clamping mechanism.

⚠ WARNING!



RISK OF ELECTRIC SHOCK DURING MAINTENANCE AND CLEANING WORK!

Dangerous voltage on exposed live parts.

- ▶ Switch off the packaging machine during maintenance and cleaning work.
- ▶ Disconnect the packaging machine from the mains.
- ▶ During maintenance work, check that all poles are free of voltage.

⚠ CAUTION!



RISK OF CUTTING HANDS!

The mechanically driven blades can cause serious injury to hands.

- ▶ Switch off the packaging machine during installation, cleaning and maintenance work.
- ▶ Disconnect the packaging machine from the mains.
- ▶ Wear protective gloves during maintenance and cleaning work.

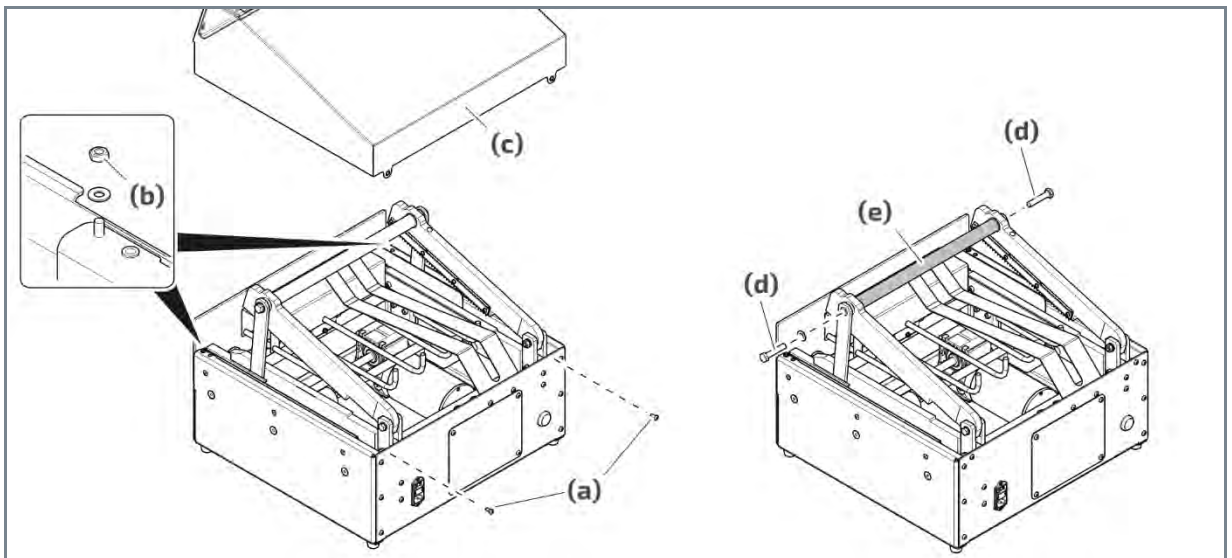

Fig. 7 Removal of jammed product

1. Switch off the machine and unplug the power cable.
2. Remove the two M5 hexagon socket screws **Fig. 7 (a)** on the back of the machine.
3. Open the drawer and remove the two M4 hexagon nuts incl. washers **Fig. 7 (b)**.
4. Remove the housing cover **Fig. 7 (c)**.
5. Loosen the two M10 hexagon head screws **Fig. 7 (d)** on the cross bar **Fig. 7 (e)**.
6. Loosen the clamping mechanism to remove the jammed product. If necessary, remove the M10 hexagon head screws to remove the cross bar **Fig. 7 (e)**.

5.4 Replacing the blade

WARNING!



RISK OF ELECTRIC SHOCK DURING MAINTENANCE WORK!

Dangerous voltage on exposed live parts.

- ▶ Switch off the packaging machine during maintenance work.
- ▶ Disconnect the packaging machine from the mains.
- ▶ During maintenance work, check that all poles are free of voltage.

CAUTION!



RISK OF CUTTING HANDS!

The mechanically driven blades can cause serious injury to hands.

- ▶ Switch off the packaging machine during installation, cleaning and maintenance work.
- ▶ Disconnect the packaging machine from the mains.
- ▶ Wear protective gloves during maintenance and cleaning work.

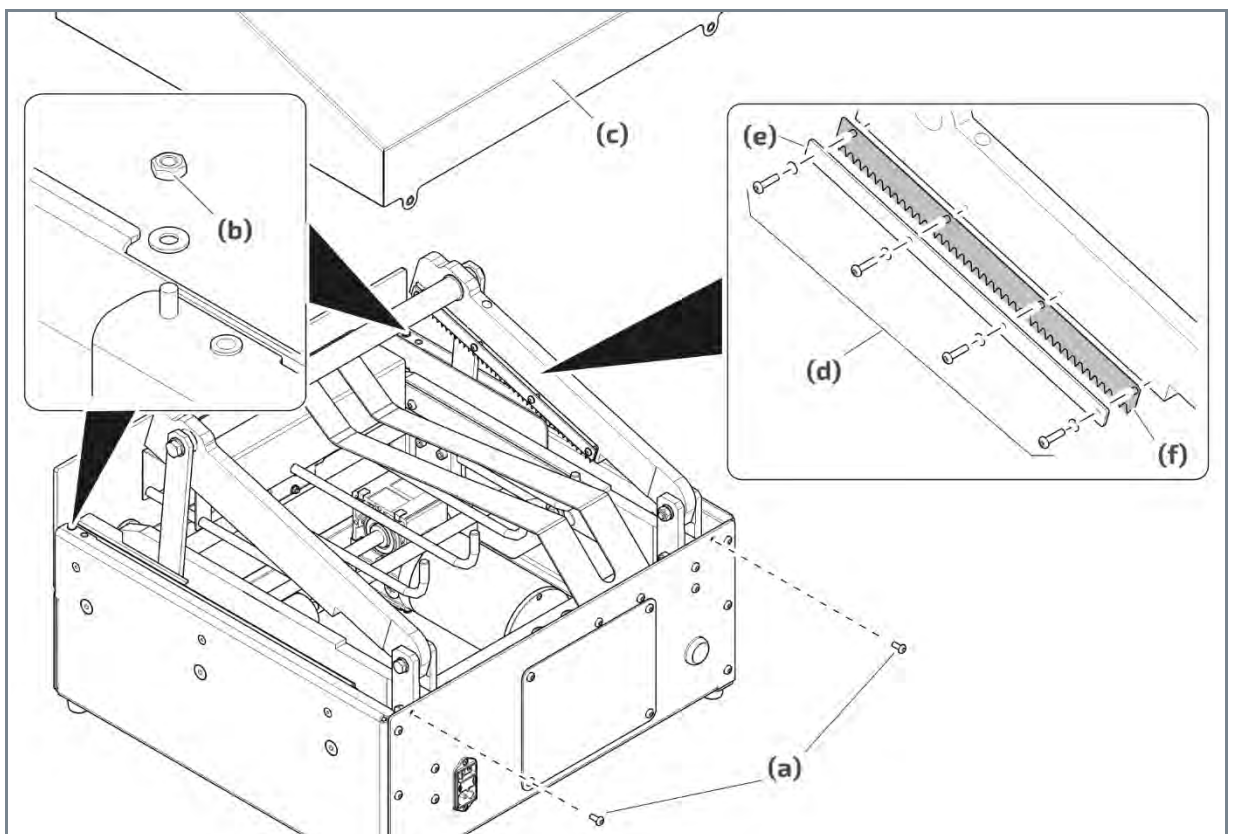

Fig. 8 Replacing the blade

1. Switch off the machine and unplug the power cable.
2. Remove the two M5 hexagon socket screws **Fig. 8 (a)** on the back of the machine.
3. Open the drawer and remove the two M4 hexagon nuts incl. washers **Fig. 8 (b)**.
4. Remove the housing cover **Fig. 8 (c)**.



5. Remove the four M4 hexagon socket screws, including the washers, **Fig. 8 (d)** and remove the clamping strip **Fig. 8 (e)**.
6. Replace the blade **Fig. 8 (f)** and screw it together with the clamping strip **Fig. 8 (e)** and M4 hexagon socket head screws, including the washers, **Fig. 8 (d)**.
7. Make sure that the knife is screwed evenly and parallel to the clamping strip.
8. Place the housing cover **Fig. 8 (c)** on the housing and screw it on with the two M4 hexagon nuts, including the washers, **Fig. 8 (b)** and the two M5 hexagon socket screws **Fig. 8 (a)** on the back of the machine.
 - ↳ The replacement of the blade is completed.

5.5 Replacing the fuse

WARNING!



RISK OF ELECTRIC SHOCK DURING MAINTENANCE WORK!

Dangerous voltage on exposed live parts.

- ▶ Switch off the packaging machine during maintenance work.
- ▶ Disconnect the packaging machine from the mains.
- ▶ During maintenance work, check that all poles are free of voltage.

NOTE



DAMAGE TO EQUIPMENT! SHORT CIRCUIT!

The machine may be damaged if the wrong fuse is used.

- ▶ Only use fuses that correspond to the fuses of the power supply module.

Fuse type:	IEC Standard fuse
Nominal voltage:	250 V AC
Nominal current:	0,02 A – 20 A
Breaking capacity:	35 A – 125 A

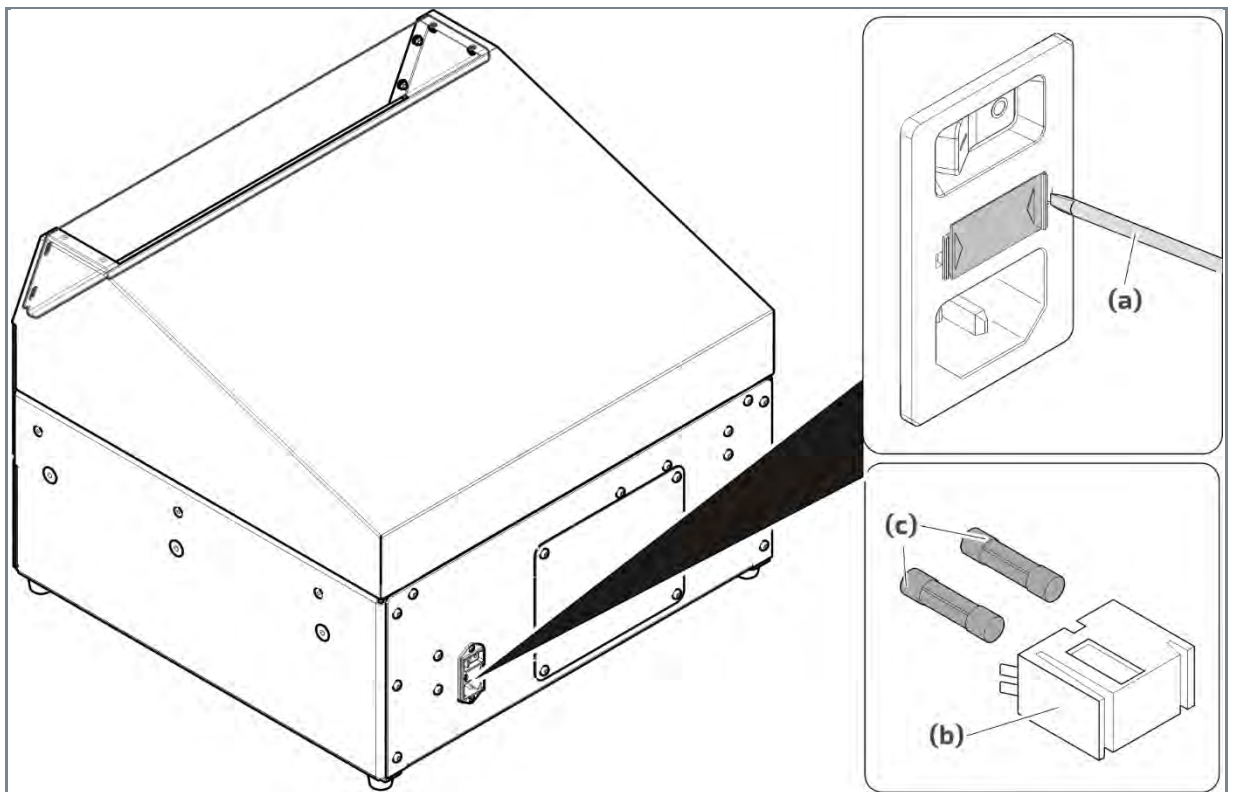

Fig. 9 Replacing the fuse

1. Switch off the machine and unplug the power cable.
2. Remove the fuse holder **Fig. 9 (b)** from the power supply module using a screwdriver **Fig. 9 (a)**.
3. Remove the fuses **Fig. 9 (c)**.
4. Insert the new fuses and replace the holder.
 - ↳ The fuse change has been completed.

5.6 Cleaning

5.6.1 Cleaning the housing

⚠ WARNING!



RISK OF ELECTRIC SHOCK DURING CLEANING!

Dangerous voltage on exposed live parts.

- ▶ Switch off the packaging machine during cleaning.
- ▶ Disconnect the packaging machine from the mains.

NOTE



DAMAGE CAUSED BY INCORRECT CLEANING METHODS AND AGENTS!

Cleaning using high pressure, compressed air, steam jet, aggressive solvents or abrasives may damage the machine.

- ▶ Use normal detergent and a cleaning cloth for cleaning.

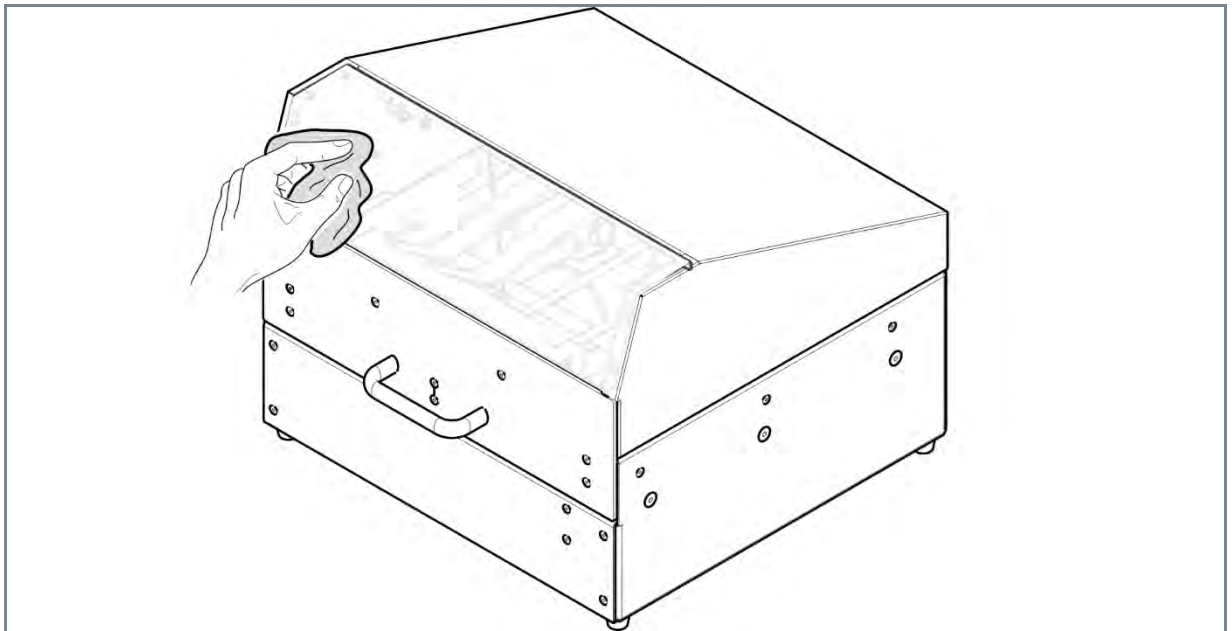

Fig. 10 Cleaning the housing

1. Switch off the packaging machine and unplug the power cable.
2. Spray cleaning agent onto the cleaning cloth.
3. Clean all surfaces of the packaging machine.
 - ↳ Cleaning is completed.

5.6.2 Removing cardboard residues

Cleaning inside the machine is only necessary if a blank has become jammed and cardboard residues have accumulated as a result.

WARNING!



RISK OF ELECTRIC SHOCK DURING CLEANING!

Dangerous voltage on exposed live parts.

- ▶ Switch off the packaging machine during cleaning.
- ▶ Disconnect the packaging machine from the mains.

CAUTION!



RISK OF CUTTING HANDS!

The mechanically driven blades can cause serious injury to hands.

- ▶ Switch off the packaging machine during installation, cleaning and maintenance work.
- ▶ Disconnect the packaging machine from the mains.
- ▶ Wear protective gloves during maintenance and cleaning work.

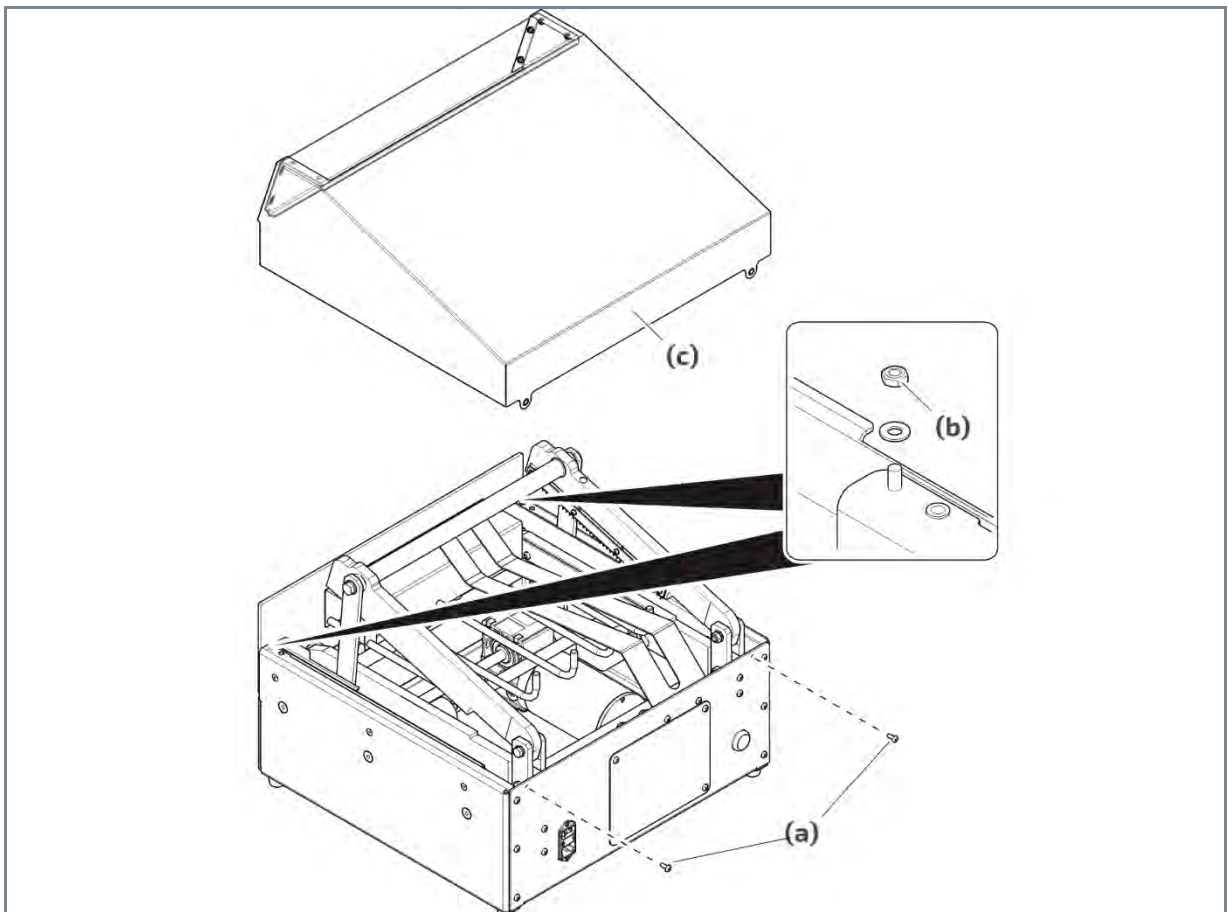

Fig. 11 Cleaning the interior

1. Switch off the machine and unplug the power cable.
2. Remove the two M5 hexagon socket screws **Fig. 11 (a)** on the back of the machine.
3. Open the drawer and remove the two M4 hexagon nuts, including the washers, **Fig. 11 (b)**.



4. Remove the housing cover **Fig. 11 (c)**.
5. Remove all cardboard residues completely.
6. Place the housing cover **Fig. 11 (c)** on the housing and screw it on with the two M4 hexagon nuts, including the washers, **Fig. 11 (b)** and the two M5 hexagon socket screws **Fig. 11 (a)** on the back of the machine.
 - ↳ Cleaning is completed.

6 Decommissioning and disposal

The device may only be decommissioned by specialised personnel (see section 2.3).

6.1 Decommissioning

⚠ WARNING!



RISK OF ELECTRIC SHOCK DURING DECOMMISSIONING!

Dangerous voltage on exposed live parts.

- ▶ Switch off the packaging machine.
- ▶ Disconnect the machine from the mains.
- ▶ During decommissioning, check that all poles are free of voltage
- ▶ When decommissioning, check that the power supply is disconnected from all poles.

⚠ CAUTION!



RISK OF INJURY FROM HEAVY AND UNWIELDY MACHINERY!

- ▶ Machine to be transported by at least 2 persons.

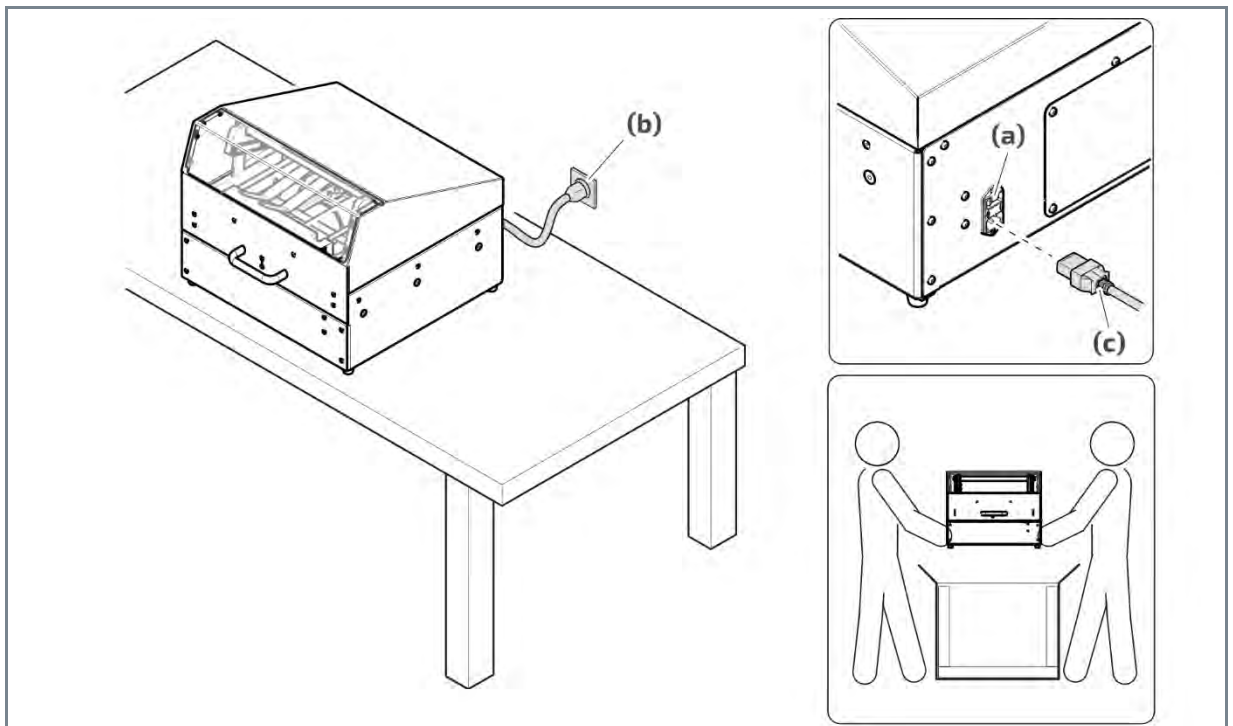

Fig. 12 Decommissioning the packaging machine

1. Switch the main switch **Fig. 12 (a)** of the packaging machine to "0".
2. Unplug the power cable **Fig. 12 (b)** and **(c)**.
 - ↳ The machine has been properly decommissioned.

6.2 Disposal

If the product has reached the end of its useful life, have it disposed of by a specialist disposal company in accordance with statutory regulations.



7 Technical data

7.1 Machine dimensions

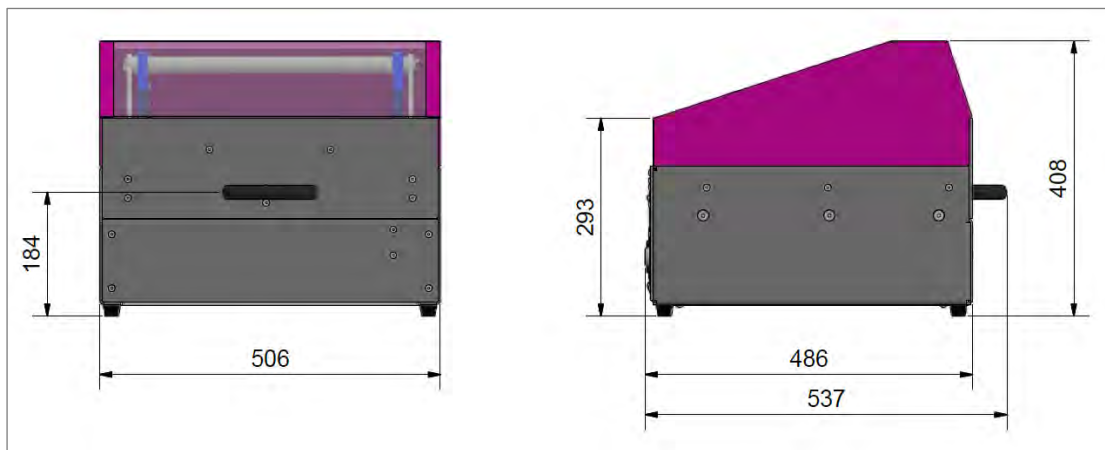

Fig. 13 Machine dimensions

7.2 Information plate and further electrical characteristics

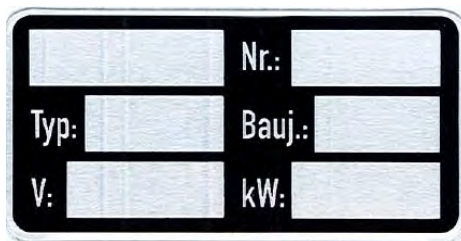

Fig. 14 Information plate

Model:	WaveWrap®
Serial number:	see information plate
Type:	WW
Year of manufacture:	see information plate
Voltage:	230V
Power output:	0,11kW
Mains frequency:	50Hz
Power consumption:	0.23mA
Weight:	35kg

8 Appendix

8.1 EC Declaration of Conformity

	WavePack® GmbH Fabrikstrasse 15 D-79771 Klettgau-Erzingen	Tel. +49 (0) 7742 9169 195 UStD-Nr. DE306859983 www.wavewrap.eu info@wavepack.eu
--	-----------------------------------------------------------------	-------------------------------------------------------------------------------------------

CE-Konformitätserklärung
CE declaration of conformity

Hiermit erklären wir, dass die WaveWrap®-Maschine folgenden Richtlinien und Normen entspricht (gültig ab 01.02.2019).
Herewith we declare that the WaveWrap®-machine complies with the following guidelines and standards (valid from 01.02.2019).

Serien-Nummer: Serial number	WW- _____
EG-Maschinenrichtlinie Machinery directive	2006/42/EG
Niederspannungsrichtlinie Low voltage directive	2014/35/EU
WEEE-Richtlinie WEEE-directive	2012/19/EU
RoHS-Richtlinie RoHS-direktive	2011/65/EG
Harmonisierte Normen Harmonized standards	EN ISO 12100/2010_11 EN 60204-1/2007_06 EN ISO 13857/2008_06 EN 61000-6-1/2007_10 EN 61000-6-3/2011_09

Verantwortliche Personen für die technischen Unterlagen, Name und Adresse siehe unten.
Responsible persons for the technical documentation, name and address see below.

Livio Marchioni
CEO

Geschäftsführer: Livio Marchioni | Sitz der Gesellschaft: Klettgau-Erzingen | Handelsregister Freiburg i. Br. |
Sparkasse Engen-Gottmadingen (BLZ 602 514 45) Euro Kt.-Nr. 5630546 | IBAN DE 76 6925 7405 0005630546